

NitroSprings™

PACKED WITH ADVANCED FEATURES, NITROSPRINGS PROVIDES UNRIVALLED PERFORMANCE, FUNCTIONALITY AND DURABILITY...

The various features available to this range offers the perfect solution; from advanced sealing systems that provide ultimate durability, to the versatility of being able to accurately adjust gas spring force in situ. Not to mention, our full service, including design, application consultancy, and prototyping means we provide more than just a product.

STANDARD TECHNICAL SPECIFICATIONS

Custom NitroSprings available upon request

Range Overview				
	NS-20-40	NS-SS-20-40	NS-16-40	NS-SS-16-40
Rod Diameter:	20mm	20mm	16mm	16mm
Body Diameter:	40mm	42mm	42mm	42mm
Stroke Lengths:	Up to 900mm		Up to 900mm	
Threads:	M14x1.5x15mm		M14x1.5x15mm	
Force Range:	300 - 5000N		200 - 3600N	
Force Progression:	40 - 50%		15 - 20%	
Extension Speed:	-0.3m/s		-0.3m/s	
Working Temp. Range:	-30°C - 80°C		-30°C - 80°C	
Material:	Carbon Steel	Stainless Steel 316	Carbon Steel	Stainless Steel 316
Rod:	Chrome Plated	Chrome Plated	Chrome Plated	Chrome Plated
Body Finish:	Black Powder Coating	Stainless Steel 316	Black Powder Coating	Stainless Steel 316
Guarantee:	2 years against manufacturing defects		2 years against manufacturing defects	



NS-20-40 - Adjustable Forces		
Catalogue Code	Force Range N	Stroke Length (S) mm / Extended Length (L) mm
NS-20-40-100	100	311
NS-20-40-150	150	411
NS-20-40-200	200	511
NS-20-40-250	250	611
NS-20-40-300	300	711
NS-20-40-350	350	811
NS-20-40-400	400	911
NS-20-40-450	450	1011
NS-20-40-500	500	1111
NS-20-40-600	600	1311
NS-20-40-700	700	1511
NS-20-40-800	800	1711
NS-20-40-900	900	1911

NS-16-40 - Adjustable Forces		
Catalogue Code	Force Range N	Stroke Length (S) mm / Extended Length (L) mm
NS-16-40-100	100	311
NS-16-40-150	150	411
NS-16-40-200	200	511
NS-16-40-250	250	611
NS-16-40-300	300	711
NS-16-40-350	350	811
NS-16-40-400	400	911
NS-16-40-450	450	1011
NS-16-40-500	500	1111
NS-16-40-600	600	1311
NS-16-40-700	700	1511
NS-16-40-800	800	1711
NS-16-40-900	900	1911

New low force progression version

Rod wipers that prevent ingress of contaminants that can reduce gas spring life.

Tertiary wiper system comprises dual role redundancies. (See parts highlighted)

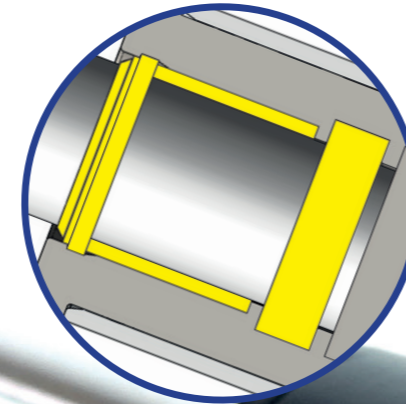

NASS (NitroSpring Advanced Sealing Systems) combination of specialist seal solutions offers unrivalled performance and durability compared to other gas spring products.

Advanced two stage sealing system. (See parts highlighted)

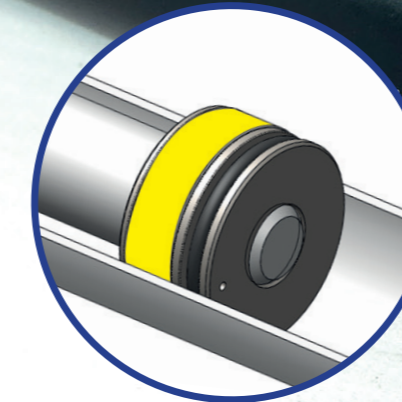
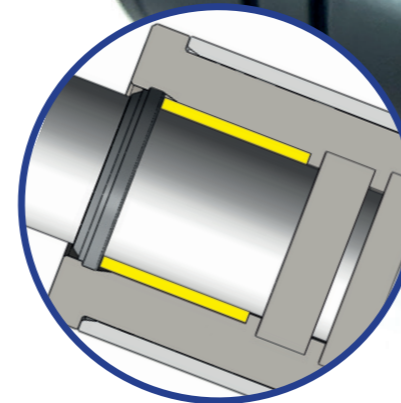
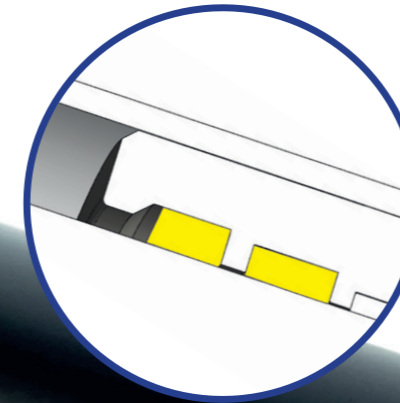

Scan here for more information and technical specifications:

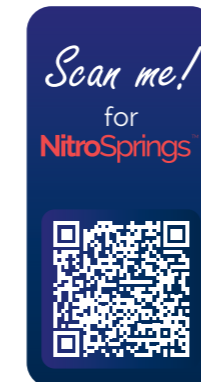

Enhanced dual guidance system, reducing the effects of lateral loads and improving longevity for seals.

Tandem rod guidance components. (See parts highlighted)

Precision and versatility is a top priority of ours...

We've designed the range with this in mind. Therefore, you can adjust the force of NitroSpring products yourself, in a controlled manner with high accuracy. This can be done in the field, without having to remove it from the application, the ultimate in true versatility.

PAV (Precision Adjustment Valve) side port allows accurate adjustment of pressure.

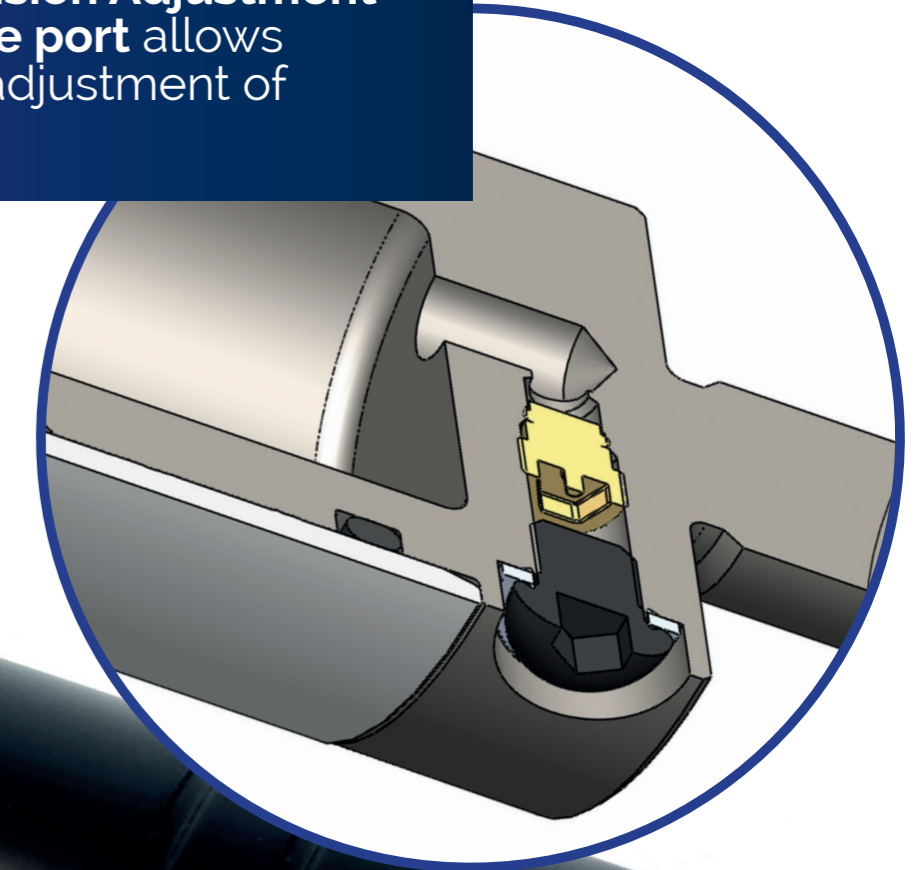

Stainless steel 316 material available

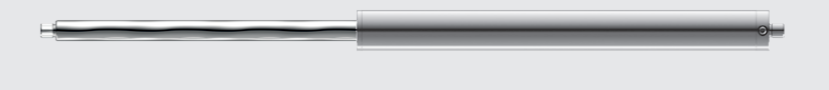

NitroSprings™

FORCE ADJUSTMENT

Using the cylinder side located PAV (Precision Adjustment Valve), the following accessories provide the means to simply reduce the force, or the ability to increase and reduce the force.



STANDARD END FITTINGS

Type	Material	Code
Ball Joint		B16
Eye End	Steel	E14
Clevis Fork		C4
Rose Eye		RE16

Stainless steel 316 material available

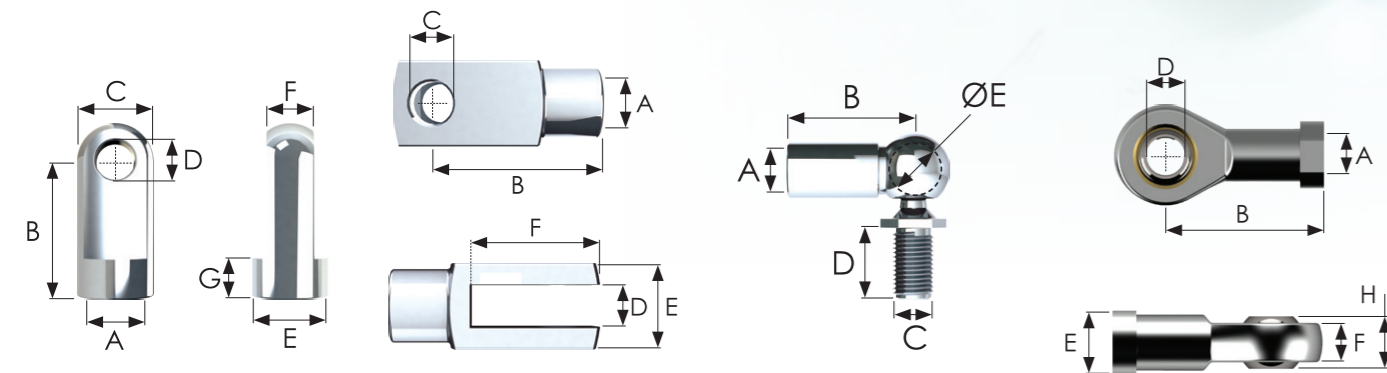

CODE	A	B	C	D	E	F	G
E14	M14	40	25	14	25	13.8	20

CODE	A	B	C	D	E	F
C4	M14	56	14	14	27	44

CODE	A	B	C	D	E
B16	M14	45	M14	28	20

CODE	A	B	D	E	F	H
RE16	M14	57	14	22	13.5	19

Lesjöfors worldwide

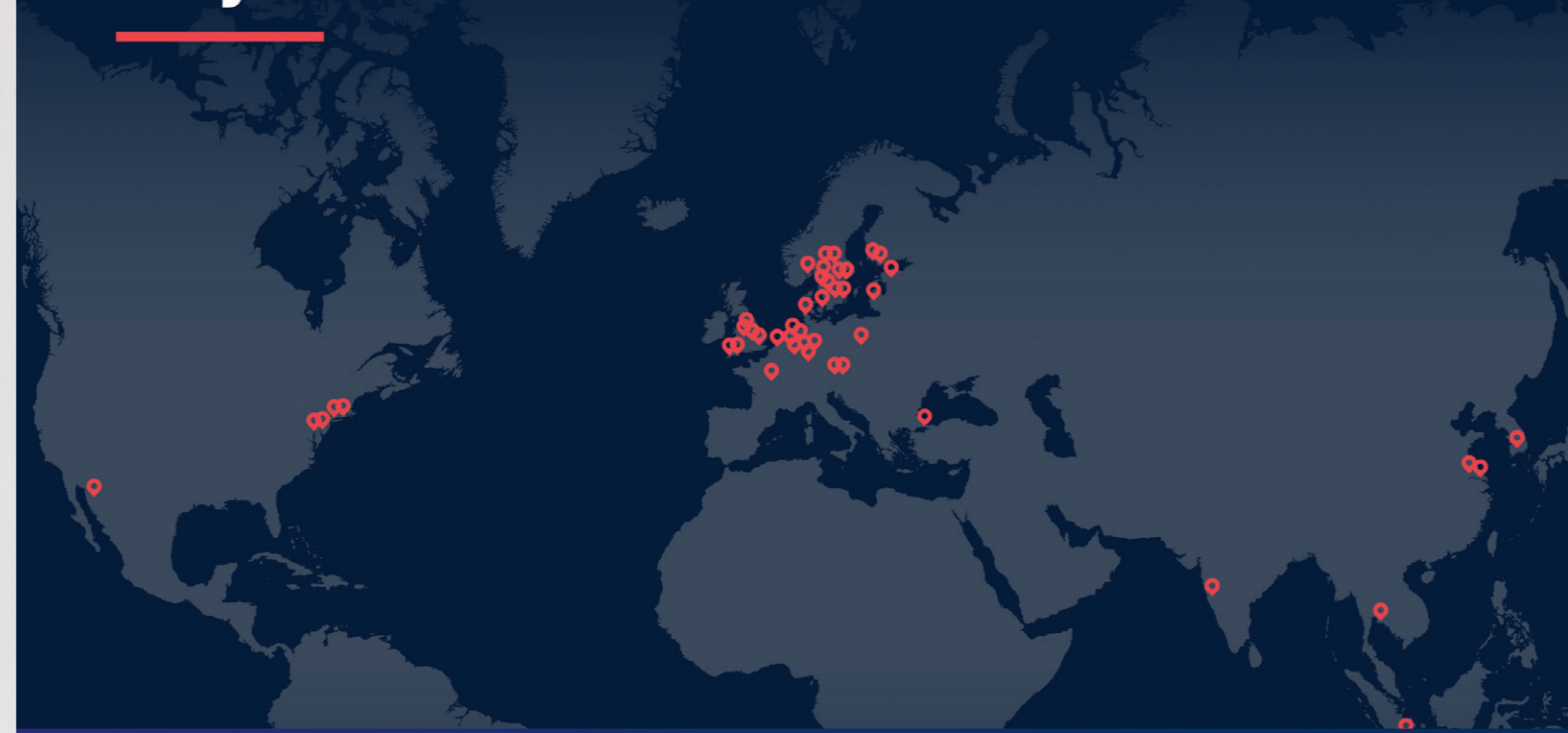

Available, serviced and supported through the Lesjöfors global distribution network.



Prototyping



CAD Design



Technical Calculations



Field Testing



Production



FEA Analysis

METROL
Part of Lesjöfors Group

Phone: +44(0)1604 499 332
Email: sales@metrol.com
Website: www.metrol.com

5 Clayfield Close, Moulton Park Industrial Estate, Northampton, NN3 6QF, UK

METROL
Part of Lesjöfors Group

NitroSprings™

LONG STROKE, HEAVY DUTY GAS SPRINGS

Standard Stock Brochure

